



# TR sensors

## Split-core current sensors

used with DIRIS Digiware and DIRIS B-30



TR split-core current sensors

### Function

TR smart **current sensors** measure the load currents of an electrical system and send the data to meters and measurement hubs via an RJ12 plug-and-play output. Thanks to a wide measurement range, TR current sensors cover the full current range of 25 to 600 A, with 4 references.

TR split-core current sensors can be connected to DIRIS Digiware and DIRIS B-30 via a rapid RJ12 connection.

### Advantages

#### Plug & Play

- A rapid RJ12 connection makes wiring easy and reliable and prevents wiring errors. This also allows automatic detection of the sensor type and size/transformation ratio.
- The sensors can be installed in both directions.

#### Accuracy as per standard IEC 61557-12

- Class 1 for the global measuring chain (measurement hub + TR current sensors) from 2 to 120% of the nominal current  $I_n$ .

#### Installation

- The TR split-core sensor range is specially designed for existing installations and site renovations.

### The solution for

- > Industry
- > Building
- > Infrastructure
- > Data center



### Strong points

- > Plug & Play
- > Accuracy as per standard IEC 61557-12
- > Installation

### Conformity to standards

- > IEC 61557-12



- > ISO 14025



- > UL



## Mounting

Cable mounting

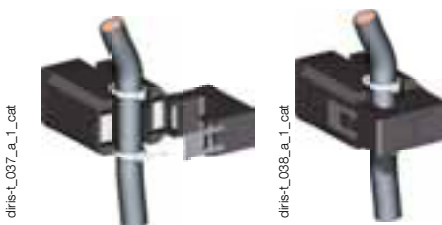

## Dimensions

TR-10 / TR-16 / TR-24 / TR-36

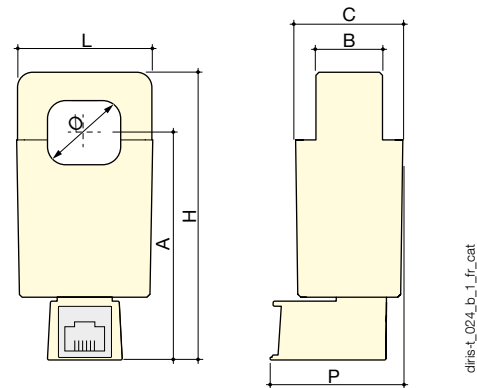

## Accessories

### Sealable cover

- Using a sealable cover guarantees the immunity of the sensor connection on TE/TR/TF current sensors.



Model	Nominal current range (A)	Actual coverage range (A)	H x W x D (mm)	Ø (mm)	A (mm)	B (mm)	C (mm)
TR-10	25 ... 75	0.5 ... 90	71 x 25 x 39	10	58	14.5	26
TR-16	32 ... 100	0.64 ... 120	74 x 30 x 42	16	61	19	31
TR-24	63 ... 200	1.26 ... 200	95 x 45 x 44	24	72	22	34
TR-36	200 ... 600	4 ... 720	111 x 57 x 42	36	82	34	40.5

## Specifications

### TR - Split-core sensor

Model	TR-10	TR-16	TR-24	TR-36
Nominal current range $I_n$ (A)	25 ... 75	32 ... 100	63 ... 200	200 ... 600
Actual coverage range (A)	0.5 ... 90	0.64 ... 120	1.26 ... 240	4 ... 720
Max. current (A)	90	120	240	720
Weight (g)	74	117	211	311
Max. voltage (phase/neutral)	300 V			
Rated withstand voltage	3 kV			
Frequency	50/60 Hz			
Intermittent overload	10 x $I_n$ for 1s			
Measurement category	CAT III			
Protection degree	IP20 / IK06			
Operating temperature	-10 ... +70°C			
Storage temperature	-25 ... +85°C			
Relative humidity	95% RH non-condensing			
Altitude	< 2000 m			
Connection	Socomec RJ12 cable			

## References

Model	Nominal current range (A)	Actual coverage range (A)	Ø (mm)	Reference
TR-10	25 ... 75	0.5 ... 90	10	4829 0551
TR-16	32 ... 100	0.64 ... 120	16	4829 0552
TR-24	63 ... 200	1.26 ... 200	24	4829 0553
TR-36	200 ... 600	4 ... 720	36	4829 0554

Accessories	Reference
Sealable caps (20 pieces)	4829 0600

RJ12 connection cables	Cable length (m)								
	0.1	0.2	0.3	0.5	1	2	5	10	50 m reel + 100 connectors
Number of cables	Reference	Reference	Reference	Reference	Reference	Reference	Reference	Reference	Reference
1	-	-	-	-	-	-	4829 0602	4829 0603	4829 0601
3	4829 0580	4829 0581	4829 0582	4829 0595	4829 0583	4829 0584	-	-	-
4	-	-	-	4829 0596	4829 0588	4829 0589	-	-	-
6	4829 0590	4829 0591	4829 0592	4829 0597	4829 0593	4829 0594	-	-	-